

DIMENSIONS

mm

MBR-02

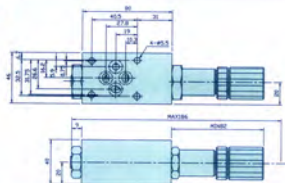

MBR-03

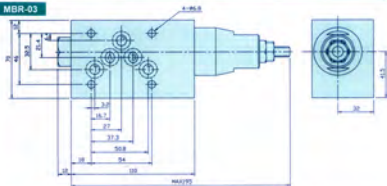

MBR-06

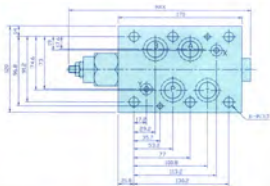



MBR-02-P



MBR-02-A



MBR-02-B



ORDERING INFORMATION

MBR-0 - - -

Pressure Range
 B: 1.5– 35 kgf/cm²
 C: 8– 70 kgf/cm²
 H: 35–250 kgf/cm²

Control Ports
 A : A Port
 B : B Port
 P : P Port

Valve Size
 1/4" (02) 3/8" (03) 3/4" (06)

MBR: Reducing Modular Valves

◆ MODEL CODE & SPECIFICATION

Types	Valve Size	Max. Flow ℓ/min	Max Pres. kgf/cm ²	Weight (Kg)
MBR-02-A	1/4" (02)	40	250	1.3
MBR-02-B	1/4" (02)	40	250	1.3
MBR-02-P	1/4" (02)	40	250	1.3
MBR-03-A	3/8" (03)	80	250	3.8
MBR-03-B	3/8" (03)	80	250	3.8
MBR-03-P	3/8" (03)	80	250	3.8
MBR-06-P	3/4" (06)	120	250	11.5

DIMENSIONS

mm

MCV-02

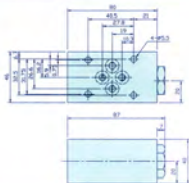

MCV-03

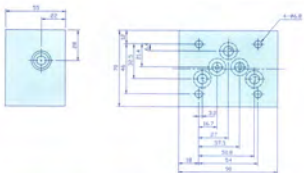

MCV-06

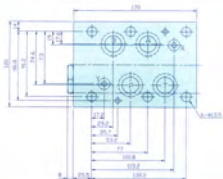



ORDERING INFORMATION

MCV-0 * - * - *

Cracking Pressure

5 : 0.5 kgf/cm²

50: 5 kgf/cm²

Control Ports

A : A Port

B : B Port

P : P Port

T : T Port

Valve Size

1/4" (02) 3/8" (03) 3/4" (06)

MCV: Check Modular Valves

◆ MODEL CODE & SPECIFICATION

Types	Valve Size	Max. Flow ℓ/min	Max Pres. kgf/cm ²	Weight (Kg)
MCV-02-A	1/4" (02)	40	250	1.0
MCV-02-B	1/4" (02)	40	250	1.0
MCV-02-P	1/4" (02)	40	250	1.0
MCV-02-T	1/4" (02)	40	250	2.0
MCV-03-A	3/8" (03)	80	250	2.8
MCV-03-B	3/8" (03)	80	250	2.8
MCV-03-P	3/8" (03)	80	250	2.8
MCV-03-T	3/8" (03)	80	250	2.8
MCV-06-P	3/4" (06)	120	250	10.5

DIMENSIONS

mm

MH(C)- 02

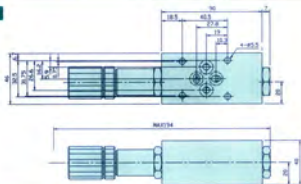

MH(C)- 03

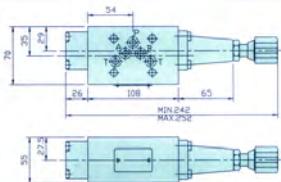

MH(C)- 06

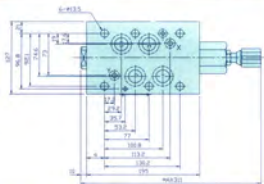



MH-02-P



MHC-02-A



MHC-02-B



ORDERING INFORMATION

MH(C)-0 - - -

Pressure Range
B: 3- 70 kgf/cm²
C: 7-160 kgf/cm²
H: 35-250 kgf/cm²

Control Ports
A : A Port
B : B Port
P : P Port (Sequence)

Valve Size
1/4" (02) 3/8" (03) 3/4" (06)

MHC: Counter Balance Modular Valves
MH: Sequence Modular Valves

◆ MODEL CODE & SPECIFICATION

Types	Valve Size	Max. Flow ℓ/min	Max Pres. kgf/cm ²	Weight (Kg)
MHC-02-A	1/4" (02)	40	250	1.4
MHC-02-B	1/4" (02)	40	250	1.4
MH-02-P	1/4" (02)	40	250	1.4
MHC-03-A	3/8" (03)	80	250	3.5
MHC-03-B	3/8" (03)	80	250	3.5
MH-03-P	3/8" (03)	80	250	3.5
MHC-06-B	3/4" (06)	120	250	14.5

DIMENSIONS

mm

MP-02

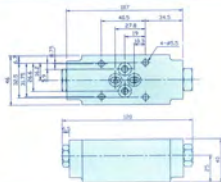

MP-03

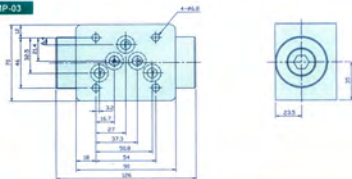

MP-06

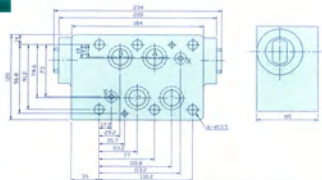



ORDERING INFORMATION

MP-0 - - -

Cracking Pressure
2 : 2 kgf/cm²
4 : 4 kgf/cm²

Control Ports
A : A Port
B : B Port
W : A & B Port

Valve Size
1/4" (02) 3/8" (03) 3/4" (06)

MP: Pilot Operated Check Modular Valves

◆ MODEL CODE & SPECIFICATION

Types	Valve Size	Max. Flow ℓ /min	Max Pres. kgf/cm ²	Weight (Kg)
MP-02-A	1/4" (02)	40	250	1.2
MP-02-B	1/4" (02)	40	250	1.2
MP-02-W	1/4" (02)	40	250	1.4
MP-03-A	3/8" (03)	80	250	3.6
MP-03-B	3/8" (03)	80	250	3.6
MP-03-W	3/8" (03)	80	250	3.9
MP-06-A	3/4" (06)	120	250	12.5
MP-06-B	3/4" (06)	120	250	12.5
MP-06-W	3/4" (06)	120	250	12.9

DIMENSIONS

mm

MR-02

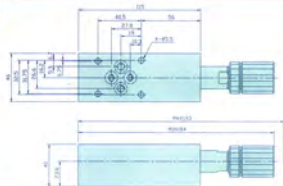

MR-03

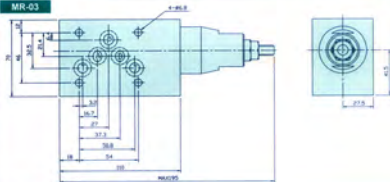

MR-06

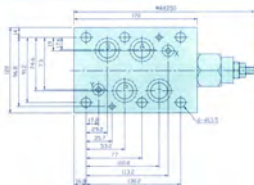



MR-02-P



MR-02-A



MR-02-B



ORDERING INFORMATION

MR-0 * * *

Pressure Range
B: 3–70 kgf/cm²
C: 7–140 kgf/cm²
H: 35–250 kgf/cm²

Control Ports
A : A Port
B : B Port
P : P Port

Valve Size
1/4" (02) 3/8" (03) 3/4" (06)

MR: Relief Modular Valves

◆ MODEL CODE & SPECIFICATION

Types	Valve Size	Max. Flow ℓ/min	Max Pres. kgf/cm ²	Weight (Kg)
MR-02-A	1/4" (02)	40	250	1.6
MR-02-B	1/4" (02)	40	250	1.6
MR-02-P	1/4" (02)	40	250	1.6
MR-02-W	1/4" (02)	40	250	2.3
MR-03-A	3/8" (03)	80	250	3.1
MR-03-B	3/8" (03)	80	250	3.1
MR-03-P	3/8" (03)	80	250	3.1
MR-03-W	3/8" (03)	80	250	3.9
MR-06-P	3/4" (06)	120	250	11.5

DIMENSIONS

mm

MT(C)-02

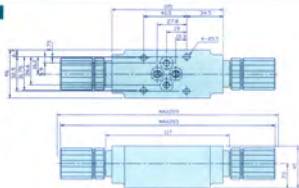

MT(C)-03

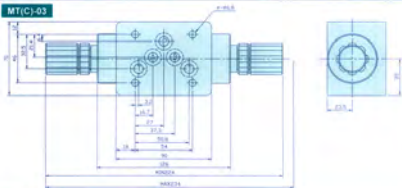

MT(C)-06

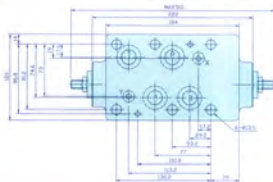

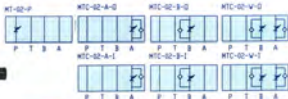

ORDERING INFORMATION

MT(C)-0 - **02** - **03** - **06**

O : Meter-Out
 I : Meter-In

Control Ports
 A : A Port
 B : B Port
 P : P Port
 W : A & B Port

Valve Size
 1/4" (02) 3/8" (03) 3/4" (06)

MT: Throttle Modular Valves
 MTC: Throttle and Check Modular Valves

◆ **MODEL CODE & SPECIFICATION**

Types	Valve Size	Max. Flow ℓ/min	Max Pres. kgf/cm ²	Weight (Kg)
MTC-02-A	1/4" (02)	40	250	1.0
MTC-02-B	1/4" (02)	40	250	1.0
MT-02-P	1/4" (02)	40	250	1.0
MTC-02-W	1/4" (02)	40	250	1.3
MTC-03-A	3/8" (03)	80	250	2.5
MTC-03-B	3/8" (03)	80	250	2.5
MT-03-P	3/8" (03)	80	250	2.5
MTC-03-W	3/8" (03)	80	250	3.1
MTC-06-A	3/4" (06)	120	250	12.2
MTC-06-B	3/4" (06)	120	250	12.2
MT-06-P	3/4" (06)	120	250	12.2
MTC-06-W	3/4" (06)	120	250	12.3



